

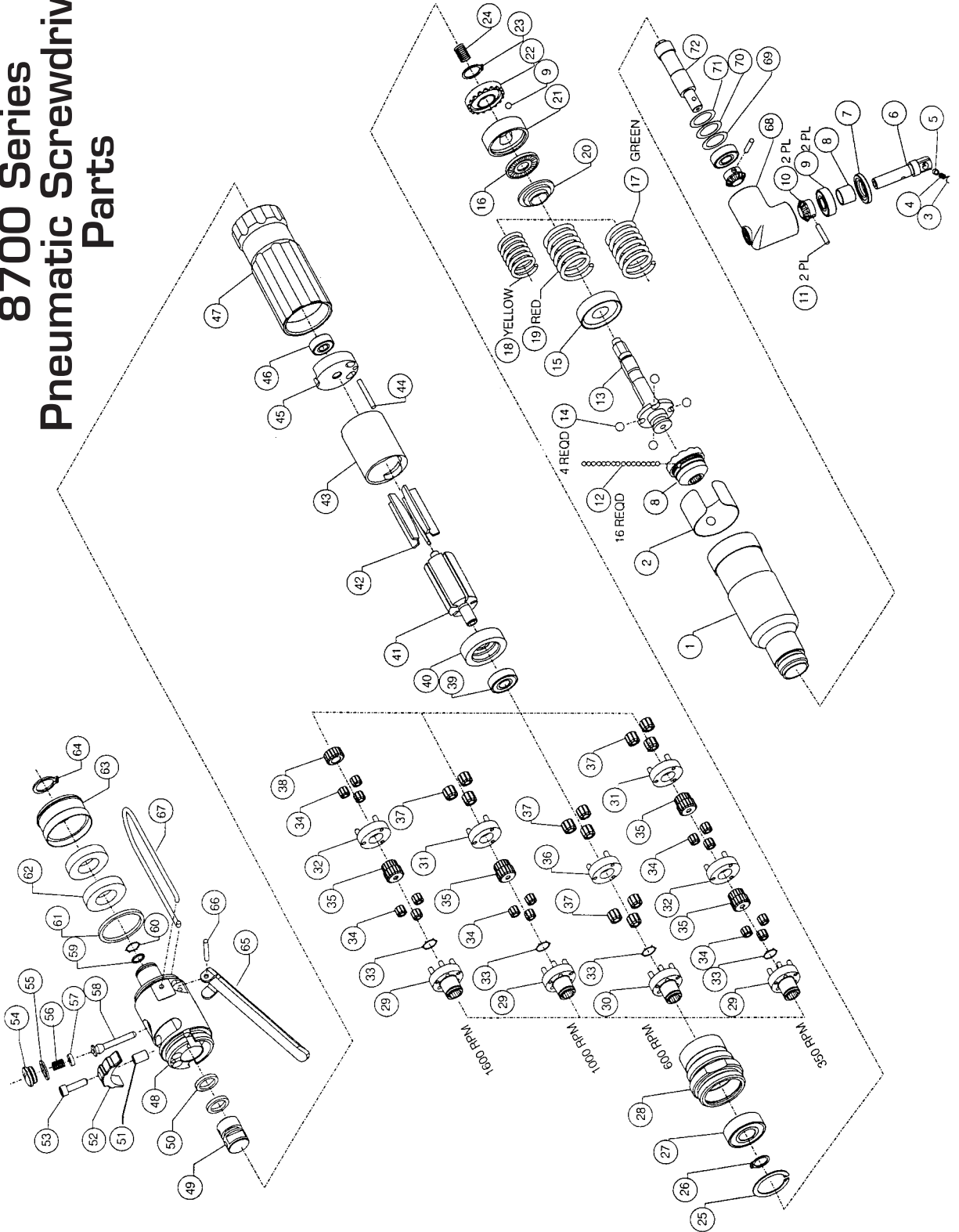

# Pneumatic Torque Tools

## 8700 Series Pneumatic Screwdriver Parts





# Pneumatic Torque Tools

Item No.	Description	Qty.	Part No.
57	O-Ring, .114 x .070, BUNA-N	1	16108
58	Valve Stem	1	9986266
59	Strainer	1	9926306
60	Ring, Retaining, INPU, .312, CST	1	9926947
61	O-Ring, .926 x .070, BUNA-N	1	9986546
62	Muffler	2	9986967
63	Sleeve, Exhaust	1	9986965
64	Ring, Retaining, Ext., .500, CST	1	9926917
65	Lever, Pneumatic	1	9986129
66	Pin, Groove, .094 x .750 CZ	1	9986167
67	Bail	1	9966371
68	Head, Right Angle, Machined	1	9986975
69	Shim, .615 OD x .438 ID x .005	1	9926040
70	Shim, .615 OD x .438 ID x .010	1	9926041
71	Shim, .615 OD x .438 ID x .015	1	9926042
72	Spindle, Input, Right Angle	1	9986978
73	Bushing	1	9936365
74	Bearing, Ball, .250 x .625 x .196W	2	9966331

Item No.	Description	Qty.	Part No.
29	Spindle, Output, 3:1	1	9986988
30	Spindle, Output, 5:1	1	9986989
31	Gear Plate Assy	1	9905711
32	Gear Plate Assy	1	9905715
33	Ring, Retaining, INPU, .312, CST	1	9926947
34	Idle Gear - Model 8401 Model 8402 Model 8404	6 3 3	9986921
35	Pinion - Model 8401 Model 8402 Model 8404	1 1 2	9986919
36	Gear Plate Assy - Model 8403	1	9905716
37	Idle Gear - Model 8402 Model 8403 Model 8404	3 6 3	9986917
38	Pinion - Model 8401	1	9986951
39	Bearing, Ball, .250 x .625 x .196W	1	9966331
40	Plate, Front	1	9986151
41	Rotor, 5:1, Cushion Clutch	1	9986970
42	Rotor Blade	5	9986913
43	Cylinder	1	9986009
44	Pin, Dowel, .094 x .750	1	9986325
45	Plate, Rear	1	9986153
46	Bearing, Ball, .188 x .500 x .196W	1	9926247
47	Motor, Housing, 3 Reduction Model 8404 Motor, Housing, 2 Reduction Models 8401, 8402, 8403	1 1 1	9986183 9986164
48	Head, Level, Slide Reverse	1	9986984
49	Valve, Slide Reverse	1	9986998
50	O-Ring, .364 x .070, BUNA-N	2	16102
51	Sleeve, Reverse Lever	1	9986999
52	Cover, Reverse Valve	1	9980025
53	Screw, SOHX, 6-32 x .50, CB NYLOCK	1	16839
54	Screw, Seal	1	9986527
55	Gasket	1	9986340
56	Spring, Comp., .205 X .383 X .022, SST	1	9986560

Item No.	Description	Qty.	Part No.
1	Housing Assy., Clutch	1	9986981
2	Spring Cover	1	9986013
3	Lock Pin	1	9971545
4	Sleeve, Chuck	1	9966348
5	Plug	1	9971546
6	Spindle, Output, Right Angle	1	9986973
7	Retainer, Bearing	1	9946347
8	Cam, Cushion Clutch, Right Angle	2	9986980
9	Ball, Steel, .125 Dia	1	9926353
10	Gear, Modified	2	9986979
11	Pin, Spring, Slot, .094 x .500	2	9986466
12	Ball, Steel, .094 Dia	16	9926349
13	Spindle, Cushion Clutch	1	9986969
14	Ball, Steel, .187 Dia	4	9996932
15	Washer, Cam Spring	1	9986161
16	Bearing, Thrust, .375 x .812 x .0781	1	9986934
17	Spring, Comp., .900 x .813 x .125, MW Green	1	9986118
18	Spring, Comp., .650 x .813 x .100, MW Yellow	1	9986933
19	Spring, Comp., .456 x .813 x .072, MW Red	1	9986932
20	Washer, Bearing Spring	1	9986931
21	Washer, Bearing Ring	1	9986115
22	Nut, Adjustment	1	9986117
23	Ring, Retaining, Ext., .312, CST	1	9926955
24	Spring, Comp., .240 x .625 x .020, MW	1	9986926
25	Ring, Retaining, Int., .875, CST	1	9986923
26	Ring, Retaining, Ext., .375, CST	1	9936906
27	Bearing, Ball, .375 x .875 x .281 W	1	9986922
28	Gear, Internal	1	9986152